

# Redefining Traditional Library Space in Support of Digital, Media, and Data Literacy

OK-ACRL Lightning Talk



Dr. Melvin Davis  
University Librarian  
Coastal Carolina University



Jennifer Hughes  
Associate University Librarian  
Coastal Carolina University



Eric Resnis  
Head of Research & Scholarship  
Coastal Carolina University



# Kimbel Library and Bryan Information Commons

- 10,000 FTE
- Library 44,000 Sq. Ft. (1977)
- Info Commons 18,000 Sq. Ft. (2012)
- Door Count 978,071
- 128,000 Physical Collection
- 15 Study Rooms
- 200 Desktops
- 900 Seats
- 2020 Makerspace
  - 1000 sq ft

# Data Driven Decisions

- Student Surveys
- Staff Surveys and Discussions
- Whiteboard Surveys
- National Trends Data
- Local Statistics and Trends

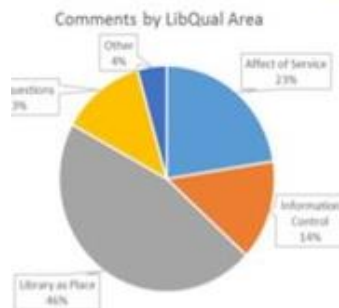
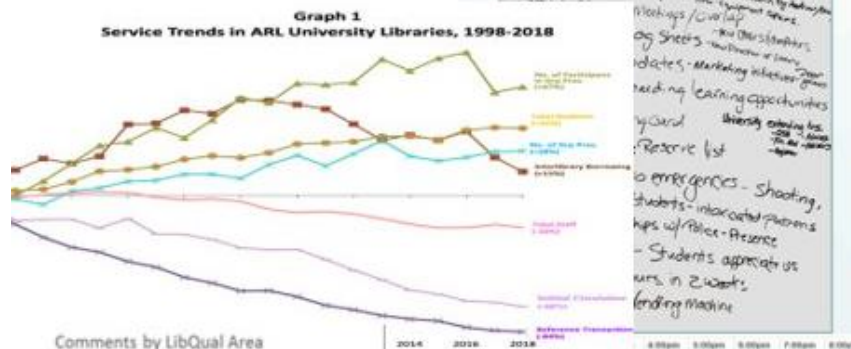
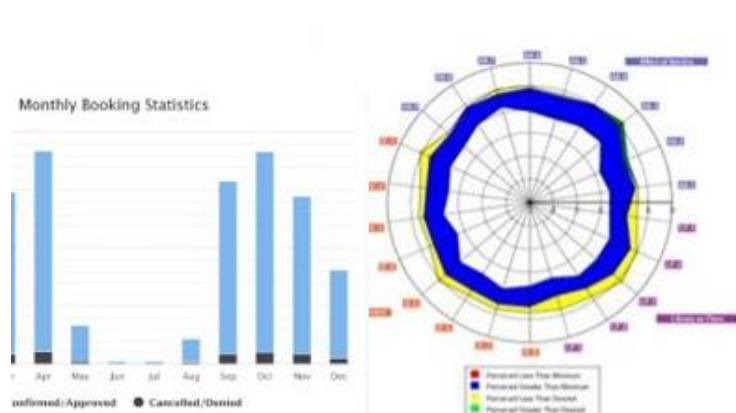

|  | Disagree (-2) | Disagree (-1) | Neutral (0) | Agree (1) |
|--|---------------|---------------|-------------|-----------|
| 1. I am satisfied with the size of my personal workspace.    | 5             | 19.2%         | 11.5%       | 53.8      |
| 2. I am satisfied with my desk.                              | 3             | 11.5%         | 15.4%       | 23.1%     |
| 3. I am satisfied with my desk chair.                        | 7             | 6.9%          | 26.9        | 38.5      |
| 4. I am satisfied with my computer.                          | 5             | 9.2%          | 38.5        | 57.7      |
| 5. I have all the software and hardware needed to fulfill my | 5             | 9.2%          | 57.7        | 23.926    |
| 6. I have adequate electrical outlets for my workspace.      | 4             | 5.4%          | 34.6        | 18,707    |

|          | General Collection Checkouts  |
|----------|-------------------------------|
| 2002-03  | 35,443                        |
| 2007-08  | 27,430 (Down 23% in 5 years)  |
| 2010-11  | 23,926 (Down 47% in 10 years) |
| 2011-12  | 22,206                        |
| 2012-13  | 18,707                        |
| 2013-14  | 17,729                        |
| 2014-15  | 15,771                        |
| 2015-16  | 12,819                        |
| 2016-17  | 11,808                        |
| 2017-18  | 11,696 (Down 67% in 15 years) |
| 2018-19  | 9,432                         |
| 2019-20* | 5,763 *                       |
| 2020-21* | 1,150 *                       |

**What Doesn't Work?**

- Too many pieces in goPro kit
- Equipment Parking
- Improper stacking/clo of laptops + equip
- Hurrying when clo
- More colored pencils

**KIMBEL WANTS TO KNOW**

Did you use an individual or collaborative group study room?

Do you prefer the ability to book group study rooms 1<sup>st</sup> come 1<sup>st</sup> serve?

Make study rooms bookable.

Have you booked a study room this semester?

YES / NO



# Library Facility Projects

## **Kimbel Library** (44,000 Sq. Ft.)

- Full Renovation of 1977 Facility
- Replace HVAC
- Seismic Improvements
- Remodel Exterior
- Gut Interior

## **Library Learning Complex** (64,000 Sq. Ft.)

- New Construction
- Adjacent to Current Library; Not Connected
- Prioritized for Student Use
- Library and Academic Support
- Strong Technology Focus

# Makerspace



## Current Tech

3D Printers (Filament)

Glowforge Laser Cutter

Large Format Printer

Sewing Machines

VR Equipment

## Maker 2.0 Tech

3D Printers (Resin, Large Format)

Direct-to-Garment Printer

Sublimation Printer

Professional Laser Cutter

Pressure Former



# Virtual Reality and Data Viz Lab

- Open and Accessible Space for Students to Explore 3D and Visualization
- Lab Allows Groups/Classes to Design, Review and Present
- Coupled with New Data Services





# Creation Studios

---

- Dedicated Studios for Professional-Quality Podcasts and Video Recordings
- Spaces Available to All Students



# University Archives and Special Collections

---

- Space to Store and Highlight University Archival Materials
- Horry County Archive Center





# Curriculum Center

- Dedicated Room for Browsing
  - Juvenile/YA Books
  - Kits, Manipulatives, STEAM Resources
  - K-12 Textbooks
  - Guided Reading Sets
- Potential Tie-in with Makerspace

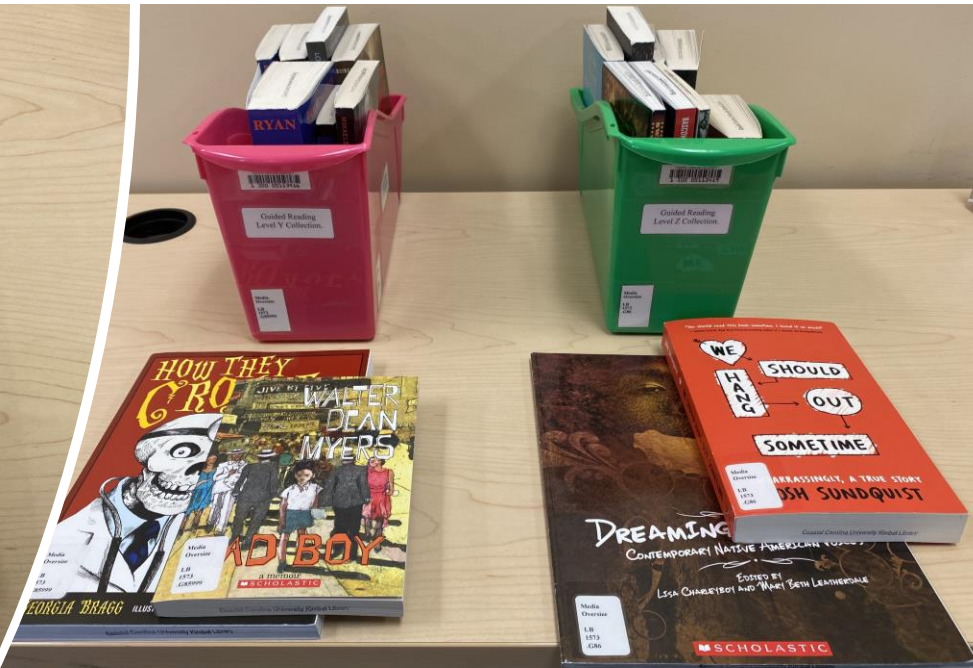
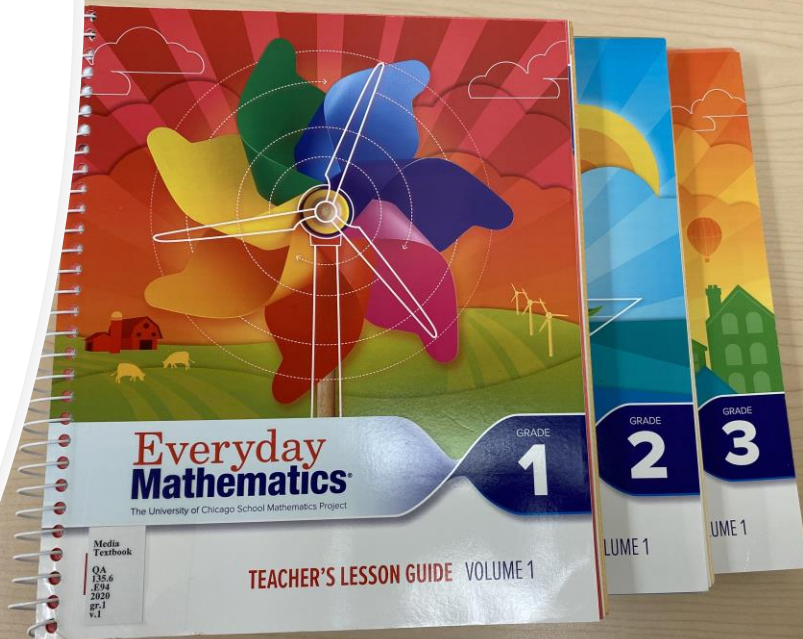

# Space Utilization

- Library 44,000 Sq. Ft.
- 10,000 Sq. Ft. of Shelving Ranges

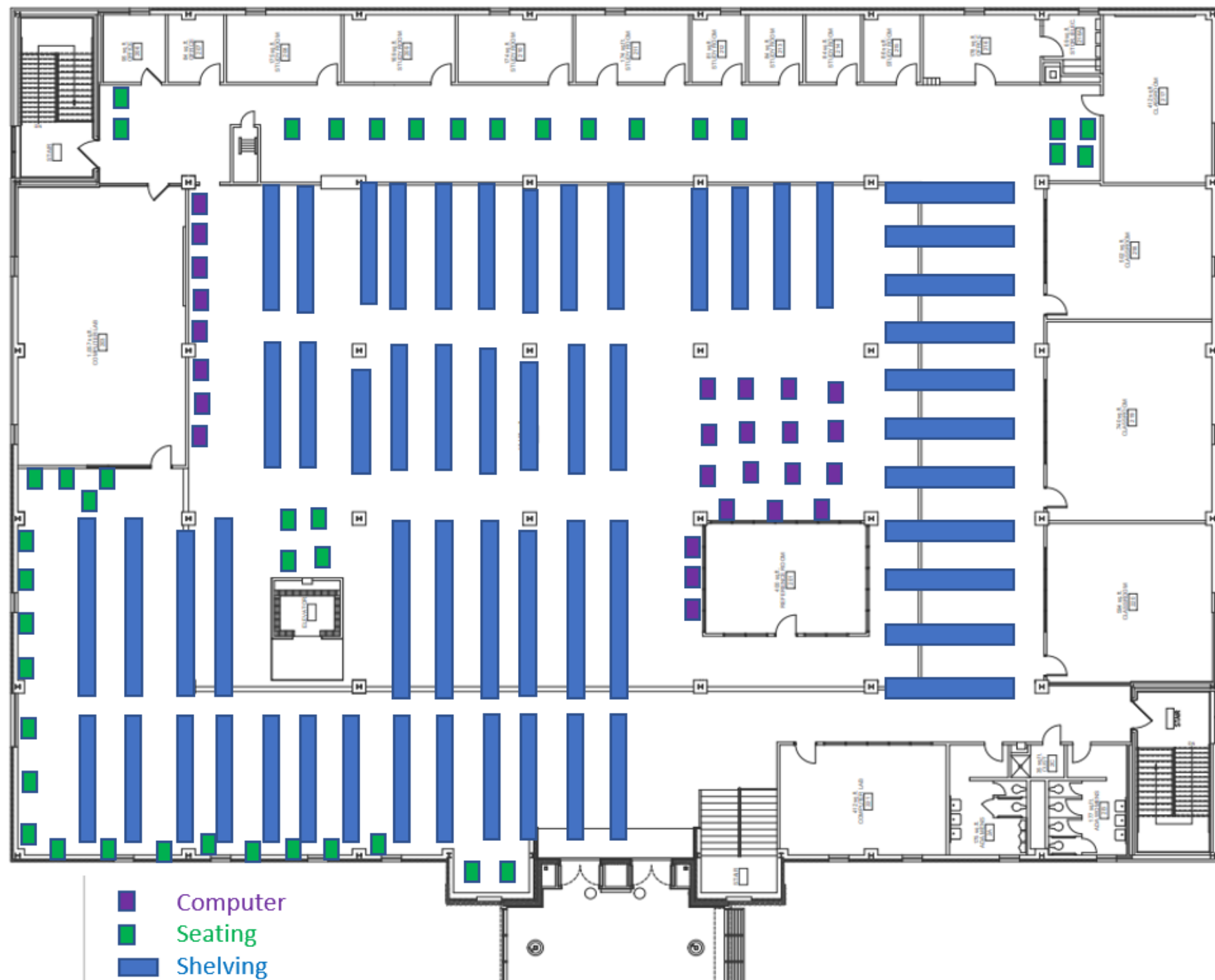



# Off-site Storage

- **Opened Summer 2022**
- \$500k Budget
- 2,700 Sq. Ft.
- Houses All Print Materials
- Archival Material Storage
- Space for ILL Processing and Digitization
- Pull materials 3 times per day
- Maximize Student Study Space in Kimbel Library





# Thompson Library

Opening Spring 2024

- \$29.8 Million Budget ; 64,000 Sq. Ft.
- Expanded Makerspace
- Data Visualization
- Creation Studios
- Access Services, Research & Scholarship, Administration
- Student Computing Lab
- Classrooms for First Year Courses
- Writing Center; Math Lab
- Student Success Center, Advising, Student Coaching
- Collaborative Study Space
- Study Rooms
- Larger Starbucks





# Kimbel Library Renovation

**Expected Opening 2025-2026**

- \$15.5 Million Budget 44,000 Sq. Ft.
- University Archives and Special Collections
- Library Technology/Collections Staff
- Quiet Study, Study Rooms
- Graduate Student Study Room
- K-12 Curriculum Materials Center
- Event Space
- HVAC and Seismic Upgrades





Prioritize Spaces That Support Digital, Media, and Data Literacy

