



TELESIS: The deliberate, purposeful utilization of the processes of nature and society to obtain particular goals. (from DESIGN FOR THE REAL WORLD, Victor Papanek)

Editor	Mark Seiley
Associate Editor	Mike Price
Associate Editor	Randy Smith
Travel Editor	Ann Hirschi

Cover: Photo-Mark Seiley
Print-Gary Ross

Telesis office-256a, Owens Stadium,
Gate 24, University
of Oklahoma

TELESIS: OPINION

The opinions expressed in these editorial columns are solely those of the student editors of TELESIS, and do not necessarily represent the viewpoint of the administration, the staff, the faculty or the student body of the University of Oklahoma.

Likewise, the views of the student columnists on these pages are strictly their own, and do not reflect the opinion of the administration, staff, faculty, student body or TELESIS editors.

TELESIS encourages letters and will read all incoming mail. Letters submitted will not be returned and may be edited or rejected by the editors based on editorial standards.

Enclosed:

1. Editorial
2. Energy: Problems & Solutions
4. News
5. Lounge Competition
6. Fountainhead & Sun Power
7. Rip a Spoon with Ralph
10. Ecology
11. W.I.A.
14. Tree Pump
16. Roses are Red
17. Violets are Blue
18. Comment & Sun
19. Bobbie Talk
20. Awards

telesistelesistelesisteles

A MONTHLY PUBLICATION OF THE O.U. SCHOOL OF ARCHITECTURE

EDITORIAL

In the past year that I have attended this University I have become very involved in the activities of the school of Architecture. In doing so I feel that I have broadened my education considerably. And I also feel that if it weren't for Prof. Kemp I might never have attempted to become involved. Many students have also expressed a similar feeling and they mainly attribute their interest to the unselfish devotion of Prof. Kemp to his students. Many a time have I rolled into his office and asked for help or materials and without any thought to his personal loss of time or money he has helped me. This paper for instance is a result of his involvement with the students, without him there would no such thing. His classic terms of "interaction" and "using it as a vehicle" have provided us with a basis to build our own personal interest in any field we enjoyed. During the short time I have known Prof. Kemp I have come to know him and greatly respect him not just because of what he is but also for what he stands for. I sincerely believe that he has provided many students like myself with a new zest for architecture and architectural awareness. It is in complete honesty that I can say that I greatly admire the man. And I feel that when he leaves this summer I will be saying good bye to a good friend. I have enjoyed this year of friendship and I hope it will continue for many years to come. And last but not least I hope Auburn appreciates what a great person they are getting and I feel they will enjoy his presence as much as we have.

Oran Sealey

editorial

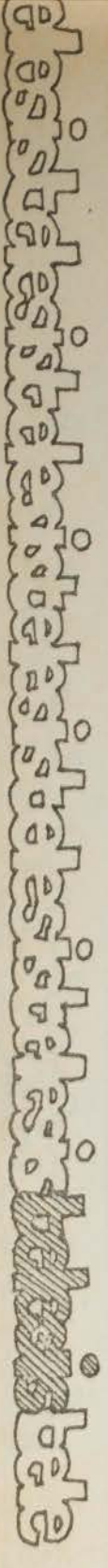

ENERGY

problems & solutions

WIND, SOLAR THERMAL CONE

by Fred Norman

Fred Norman, the local Chanel 5 television Meteorologist and OU architecture student came up with this idea to help ease the energy crisis. This invention has enough promise that Fred has applied for a patent, and in a few years you may see them used for residential power sources. We feel that Fred's solution may be an important step in the right direction to a solution to the energy problems on hand. The following is a review of the cone's producing cycle.

1. Impellar fan is driven by heated exhaust air.

Hot air exhausted from heat pump air conditioner is fed into heated chamber. This carries heat away from heat pump area, and feeds heated air into solar chamber. A furnace can do the same.

2. Black painted, or colored, heat absorbing chamber heats air from sun's rays. Cone may be circular, or shaped for maximum heating angles. Reflectors can concentrate additional rays on any, and all surfaces.

FLASH... THE EDITOR IS PREGNANT.

3. Wind panels can also be geared into drive shaft, or a windmill could also be geared into the shaft.

Wind panels shown are snapped into vertical position by any wind component from the "pushing" side, are pushed back into a horizontal, for maximum drag, by resisting air, or wind.

4. Intake air at bottom is controlled by a series of one-way, or butterfly valves, allowing only air intake, forcing all exhaust out of top exhaust vent that drives impellar.

5. Drive shaft is geared to turn D.C. or A.C. power generator.

refer

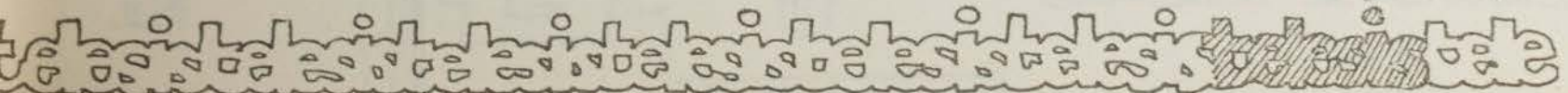

Tau Sigma Delta held its final meeting on April 19, 1974. Gary McElhaney was elected President for 1974-75. Mike Baker is the new Treasurer and Ed Woods is the new Secretary (in time for National Secretary Week). It was voted to delay a traditional gift to the School until a need is determined after the delegation of the presently available funding. Suggestions for a gift were Library materials (books, audio visuals, history slides, movies), tools and equipment for the shop, a graphic competition for the walls of the Design Lab. Tau Sigma Delta has about \$400 saved up.

The organization could not agree on an Outstanding Student Award this year. This is the first time this award has not been presented in its long history of one consecutive year.

NOTE* As next years officers are all incompetents, be sure you support them.

GOOD NEWS!!!

Mike Jordan has accepted a position on the O.U. Architecture Faculty. His appointment will start with the Fall Semester 1974. Mike will be involved in teaching Graphics and Design.

O.U. IN THE NATIONAL ASC NEWS

Student Newsletters - our plea for student news from students has netted us several fine school publications. Most are very good publications in their own right, some are absolute works of art. I think what is most intriguing about architecture student newsletters, are the names - here are a few:

- Marsharc - Tulane University
- Telesis - University of Oklahoma
- SOD - North Carolina State Univ.
- A'Archvark - Clemson
- News - University of Texas at Austin
- Ricker Reader - Univ. of Ill. at Champaign-Urbana

Keep up the good work and put us on your mailing list.

Edward Kemp will become the new arch dept head at Auburn June 1 and is leaving U Oklahoma to do so.

LAST BUT LEAST...

Oklahoma State

An irate letter scribbled on the back of a computer print-out informs the newsletter staff that once again O.U. and O.S.U. have been mistaken for one another. So here goes: First Prize winners in the Competition for Geriatric Architecture are Tom Reeder and Chris Knuth from Oklahoma State University.

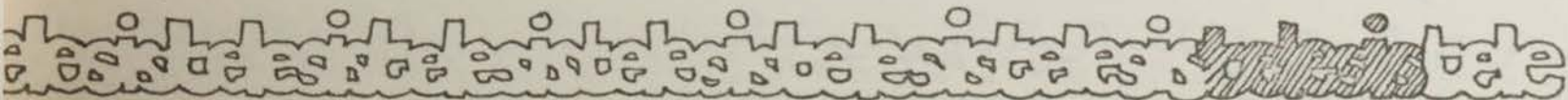

LOUNGE COMPETITION

FINE ARTS AREA STUDENT LOUNGE COMPETITION

Students in BASIC DESIGN II, SECTION III, recently competed in an in-class design competition. The project was a student lounge to be located at the corner of Boyd and Elm and was to serve students from the Schools of Art, Drama, and Music. For the design students, it was their first attempt at programming and program analysis, as well as working within the restrictions of a design competition format. The project took approximately four weeks.

The students themselves selected five finalists to be judges by individuals from the various fields which use the talents produced by the Fine Arts. Ralph Dodig, instructor, put together a panel of twelve judges which included: a construction estimator, a builder-developer, a psychologist, voice teacher from the School of Music, Business Manager from Downey Glass Co., two artists, an accountant, an O.K.C. restaurant owner, a noted area film-maker, and two O.K.C. advertising agency executives. All of the above as mentioned were familiar with some facet of the design and have volunteered to provide their services again in the future.

Below is a list of the winners and the donors who contributed the prizes. The projects are presently on display in the gallery.

FIRST	TERRY HELMS \$25.00 STEVE CHRISTIAN KENRAY ADVERTISING
SECOND	ANN HIRSCHI \$15.00 DON CUNNINGHAM GULF CONSTRUCTION CO.
THIRD	KIM KORNHAAS \$10.00 LYNN DODIG
FOURTH	TONY LAMELL \$5.00 MICHAEL REBARBER HABITAT FORMS DESIGN
FIFTH	RONNIE LEE WILLIAMS \$5.00 MALCOM HANEY KENRAY ADVERTISING

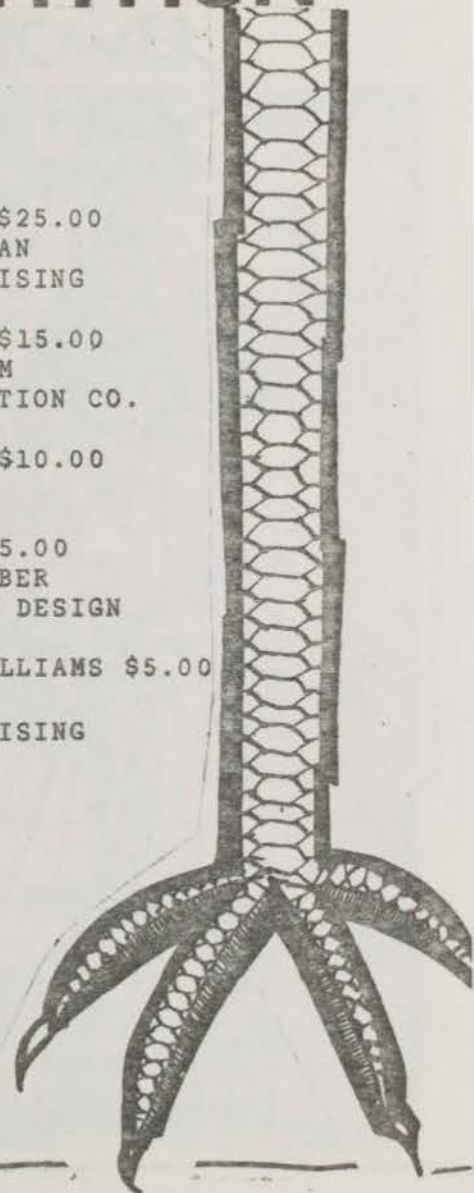

fountainhead &



SUN POWER

FOUNTAINHEAD OUTING

For those of you who failed to heed the tasteful notice of postage stamp size giving the particulars on a rousing weekend of proposed 'interaction' between 'students' and 'adults', I can only say- You've done it again!

On Saturday, April 20th at Fountainhead Lodge on Lake Eufala (one of those 'Fun for the whole family' type places) a few of us who foolishly try to keep dialogue flowing for the rest of you, rolled out HIWAY 9 into the sunrise. Little did we know what an action packed day the AIA had in store for us. Here are just a fraction of the things you missed!

- Skinny dipping with Nancy Drew
- Orgy with Wesson oil
- Arm wrestling with Howard Roark
- Obscene acts with a frisbee competition
- Unstructured round table discussion on the impotence in the AIA
- And a rehash of that favorite moldy oldie "architecture school grads of today can't draw-do da do da"

But sincerely we would like to praise those AIA members who seriously planned and attended the meeting.

SUNLIGHT FALLING ON ONE SQ.M.

MID. U.K.	latitude 52°	energy per square metre per day		YEARLY TOTAL
		MAX.	MIN.	
DIRECT		7.0	0.5	1400
DIRECT + DIFFUSE		8.4	0.8	1700

UNITS of power in kilowatt hours. Kwh. (one bar for an electric fire is usually one kilowatt.)

Printing Press Driven by Solar Energy 1882.



Printing press driven by solar energy (1882)

from: Garry: Survival Scrapbook #3.

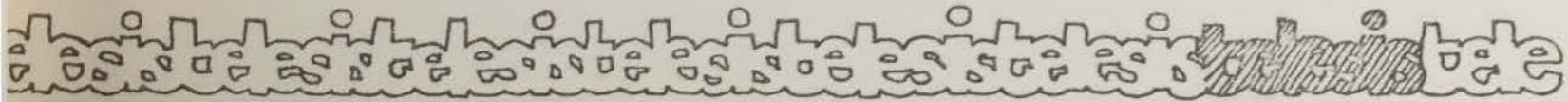

DIP A SPOON WITH RALPH

ralph dodig

DIP A SPOON WITH RALPH

I still am trying to figure out where the gum came from. I know I wasn't chewing any before I ordered my salad. As a matter of fact, I hadn't had any gum for three weeks before I ordered that salad. Oh well, that must be one of the new extras being added to the vinegar and oil dressings in Norman's flashlight dining rooms - pre-chewed Wrigleys.

This last month has been an exciting one. I have eaten out 19 times and been done in 17. Not a bad batting average for the chefs, but a helluva lot of pain and nausea for this castironed stomach gourmet.

Cantonese Villa is an interesting little place. It is housed in a quaint little chain restaurant structure originally designed for Taco Boy - Oh Boy! Taco Boy! Later after a few months T.B. went broke and the Spanish styled building took on a new line of food from another country. It became Zorba the Greeks, featuring Lebanese food.

For those of you that were never unfortunate enough to eat at Zorba's, I can attest that constipation was never the problem after Zorba got done seasoning your intestines and stomach. He never made it with his fair prices on the menu, but he retired after two months from the income provided by the pay portable sanitary units which lined the parking lot and resembled the hundreds of beech dressing huts that covered the shores of Staten Island and Miami Beech in the mid-20's.

You never understood why you got at least a \$1.50 in quarters back from paying your dining

check until you hit the parking lot. That's when Zorba's hit you, in more than one way. We'll skip the first, for I am sure that you know what I am referring to.

Those Port-A-Potties cost \$1.00 and had no vents. (Contact Dr. Calvert for requirements for proper ventilation.) The worst part of the whole ordeal was that Zorba didn't squeeze or furnish the Charmins either. That cost you another \$.50, and in checking out all 14 units and spending a total of \$21.00, running with my pants down around my ankles from unit to unit, at the moment I thought the area was clear, I discovered that none of the dispensers contained Charmins, but none the less took your \$.50 and didn't even drop a card thanking you for the contribution. I was lucky though, for earlier I had stopped at Mr. Shortstop's for a Mr. Frank's corn dog and had also purchased a package of 4 Hav-A-Hanks.

I must thank Zorba though, for previously I had had a bad case of hemmerhoids from sitting on so many well designed and soft chairs and booths in Norman's finer dining establishments, but I can tell you as a fact, that Lebanese food will sure do the trick in minutes compared to Preparation-H.

Back to C.V.. (Note: In the restaurant business, abbreviations are very essential.)

FOR LEON: #9 DOWN IS CIV SECT.

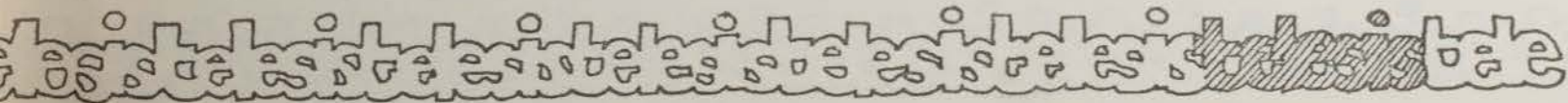

The I.Q. of those employed as waitors, chefs or bus-boys is about 13 3/4. They also say that by using an abbreviated vocabulary that the service is quicker. I will agree, for last week at Dunko's, on two separate occasions I ordered the same meal - once using abbreviations and once using the menu description. When I ordered a H.B. , no O. and FF, I got a Donut burger with no hole in the middle, with a flamingo feather in 3 1/2 minutes. It would have been quicker, but Roger Redneck, their delivery boy, couldn't get his pickup started, because the battery had run down while he was using its headlights for a searchlight at the O.K.C. Zoo's Aviary display.

On the second night when I ordered my meal from Ardele Strangebreed, in an un abbreviated manner - A HAMBURGER AND FRENCH FRIES WITH NO ONIONS, my order only took 2 days, 6 hours and 35 minutes. Both orders cost \$.93 , plus I left a 10% of check tip. (Standard when dining out.) The only difference was not only the time for my meal to be served, but also the meal. This time I got artichoke hearts in a mushroom sauce, halibut steak in a cheese sauce, anesette tea, melba toast, water bagel, used napkin, refried beans, green pepper stuffed with crab meat, extra shrimp dip, raisin bread, African King crab, Norman area map, Di-Gels, frosted long john, raw egg and honey syrup, extra maple syrup, necture from a papaya tree, creamed salmon, hot dinner rolls, fried pig snoots, rock candy, interest rate at 7% from First Federal, extra length of Rosie's quick pick-me-upper, a pair of whale skin gloves, sauterne wine (Thunderbird 1974, dated the same day), invitation to join the Norman Saddle and Round-up Club, toast (Texas style with hominy and gravy), a jar of Naval Jelly

(Manufactured in my home town), one onion ring, one toastado, nine borritos, inside tip on the next freak that the local patrons were going to assault, one free pass to the Norman Municipal Hospital, nose drops and seven glasses of water. I also got to see the second half of the pornographic tatoo on waitress Marsha Fay Wineberger's arm. What a turn on. Like what strange things Donald Duck can do with that crooked little bill.

I guess that I don't have time to get into C.V. right now, for I also promised the editor that I would get out a recipe to you too. I will tell you though that if you do patronize C.V., take an interpreter along, for the menu is 12 pages long and written in German. If you cannot find an interpreter at Coney Island or the O.K Coral, remember that item 1-35 are actually Salisbury Steak Sandwiches. Items 36-75 are Grilled Pimento Cheese Sandwiches in a sweet and sour sauce. Items 76-114 are a specialty of Canadian River Sewer Trout (scaled 3/8" = 1'-0") in a variety of sauces, mainly Mazola Oil, as there was a special on 32 oz. bottles at Sterr's last month and the establishment cleaned the shelves.

Til next month, this is Ralph inviting you to dip a spoon with me, or if you are having a problem that you can't seem to get rid of, I can recommend a place you can take him, her or them. Remember that dining out in Norman is an UNFORGETTABLE EXPERIENCE and til next month keep your pants in your pocket and a smile on your face.

more

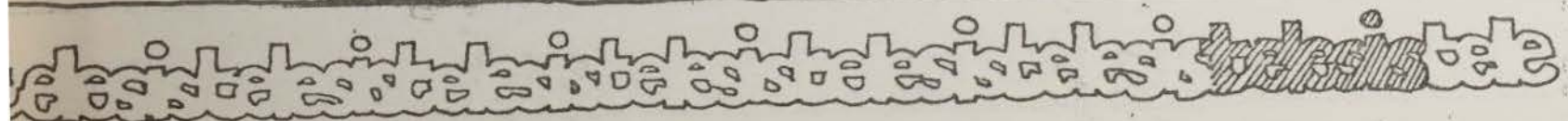

More Dip

THIS MONTH'S SECRET RECIPE:

YNAPMOC LEETS DRANATS

(This is a famous sexual potency meal, prepared by the Seven Dwarfs prior to their weekly Friday night molesting of Snow White. It is written in code as not to let out the secret. Dr. Sharp will unscramble the code for us next month.....next year..... oh what the hell...you may just try to do it on your own.)

1/4 tsp. XQNTPYON
3/4 cup ARTSNOOX
1/4 lb. RYNBPLUG
1 cup CLOMYNMB
1 dash PDQCFIL

Stir for _____ minutes over
a _____ flame.
Add 1/4 lb. NBHSTV.
Place in _____ "greased pan and
bake at _____ degrees for _____
minutes.

(I do know that this tasty dish
did change Snow's idea that she
was living with seven runts.)

Additional copies of the above recipe may be
attained by contacting TELESIS at the
address listed in Volume 1, Copy 22,
67th Edition.

We would like to have you submit recipes or
tell us your favorite place to dine in Norman.
Our new publication THE SIXTH STAR will be
coming out shortly and it will provide an in
depth guide to Norman's restaurants, as well
as a listing of all doctors, ambulance
services, pharmacists, and medical supply
facilities available to you on those nights
you choose to DINE OUT IN NORMAN*.

CRUELTY A CRITICAL CONCEPTUAL CONFUSION?

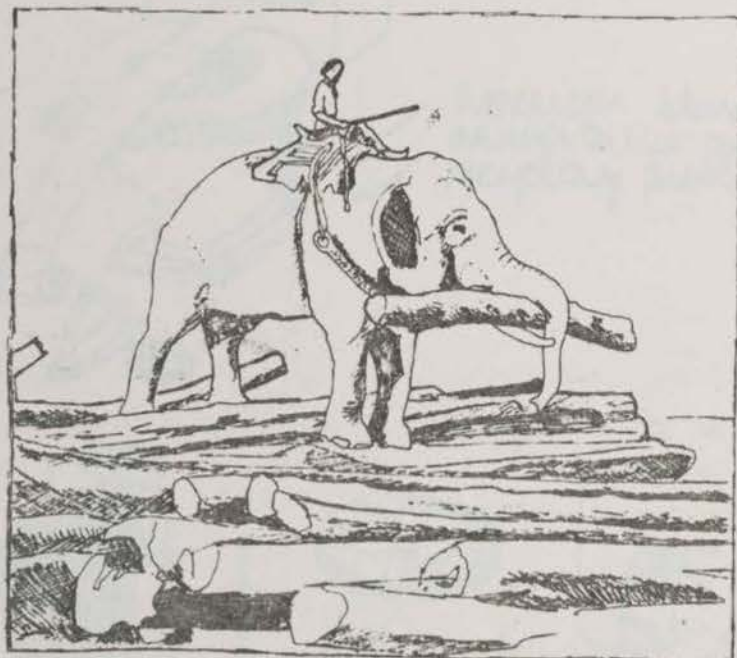

ELEPHANT LOADING TIMBER

Photo Photograph by Will P Taylor

From: Energy: Survival Blueprint #3

*Available now in paperback at \$16.95.
Hard bound collectors copies \$3.16.

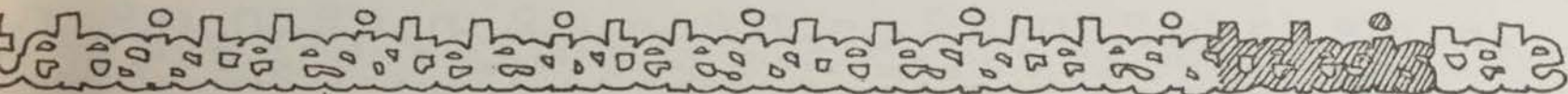

ECOLOGY

Looking at the effects of the present built environment on the earth's ecosystem it is obvious that an ecologically based environmental design is essential. Wild virgin land does the following things:

- Creates pure air
- Stores rain water
- Creates pure water
- Produces its own food
- Creates rich soil
- Uses solar energy
- Stores solar energy
- Creates silence
- Consumes its own wastes
- Maintains itself
- Matches nature's pace
- Provides wildlife habitat
- Moderates climate and weather
- IS beautiful
- Provides human habitat

When we build we do just the opposite, we fail on every point of this life list except one- human habitat. We always seem to provide that no matter what the cost environmentally. Architects of our largest and most modern hospitals, schools, and even skyscrapers fail to calculate such matter of course features as solar angles, ventilation effects, day lighting, and insulation requirements. This does not have to be. With careful design and research we can achieve, to different degrees, all of these life functions. They then have to be blended together and still have a fine functional building.

Reprint from 1973 Architectural Design

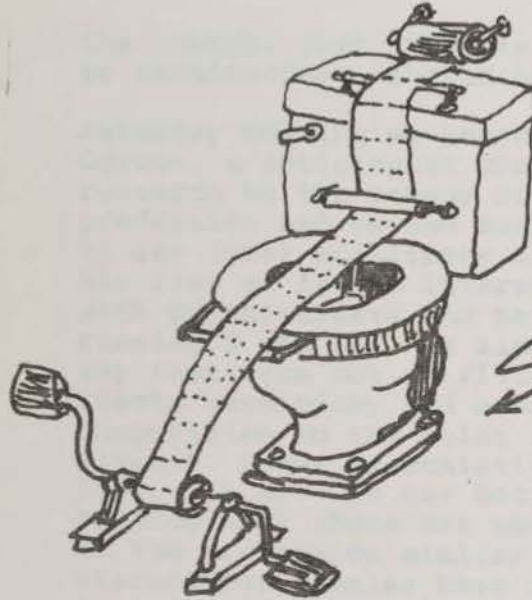

American Standard's answer to the paper recycling problem



Dog and sheep churning butter

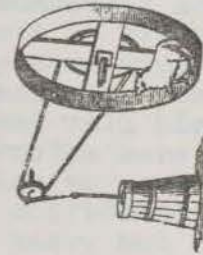

Let Fido carry his own food • Sturdy nylon, waterproof zippered panniers • Leather reinforced corners.

GET YOUR PETS TO WORK FOR THEIR KEEP ?
 # roofing panniers: kennels, work

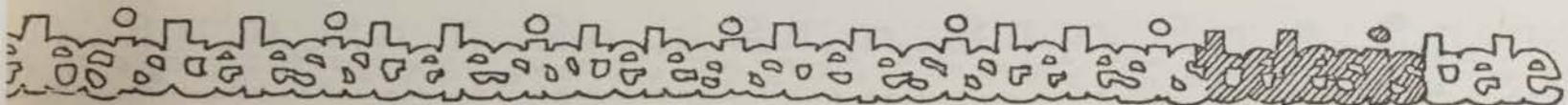



women in architecture

Ann Hirschi

(THE ESTABLISHMENT PIE IS PUTRID)

It all started innocently enough. The usual hectic registration, dealing out of nametags, and the unsuccessful, (due to the wind) hanging of a banner to shout to the world that there was a surprisingly large number of serious women in town to discuss some issues which hadn't been often addressed before.

At 7pm in Steinberg Hall of Washington University in St. Louis, Gertrude Kerbis, FAIA gave a presentation on "Architecture-Male, Female and Neuter." The talk and slide show began with the three basic forms raised to the third dimension, the pyramid, cube and sphere. Ms. Kerbis began with the pyramid, dubbed it masculine and proceeded to show slides of the Washington monument, the Trans Am building and the Price Tower, etc., to illustrate male architecture. Then we saw the sphere in the Pantheon, the Guggenheim, Bucky's domes and Goff's residences and this was named feminine architecture. From this we went to ticky tacky row boxes of the developments and it was, obviously, neuter.

Now wait just a moment! Can architecture be reduced to the breast and the phallus? Isn't this a bit simplistic or am I being predictably masochistic everytime I slave over a perspective of my round buildings? This question started the weekend off with some lively discussion and the merits of

the theory, that there is a feminine aspect to architecture, should be contended with.

Saturday morning we heard from Whitney Gordon, a sociologist who has done extensive research on the makeup of architects as a profession and he had some flattering things to say (that architects are at the top of his list as far as interesting people go-with psychiatrists and anthropologists running 2 and 3.) He also had some things to say that were not so flattering (that architects were picky and back stabbing and in competition to the point of pettyness at times.) Later masochistic was added to this list. Ah ha! Is our sociologist friend hinting that there are negative stereotypes of the profession similar to the traditional stereotypes females have and that architecture is a female profession in that it must overcome the same things that hold women back before it comes completely into its own? Another heavy bombshell dropped. Prof. Gordon typed architects as either winners (Caudell is definitely this type) being hand-shakers and businessmen, or losers like the quiet designer who cant sell himself or his architecture. The problem here is no shared meeting ground on which to work together and build our respective confidences. Again, debate raged hot and heavy but the importance of sociology to the profession was apparent. This became even clearer when more light was shed by a psychologist and a pschyitrist who have done much research on "Women profes-

st. louis blues

sionals in Architecture, Law and Medicine." This was extended into a panel discussion on role problems facing professional women.

On Saturday afternoon there were various workshops to hash out questions raised by the morning's session. I attended one very interesting one led by Corrine Kutsenkow who is an architect from San Francisco presently working on a novel about a woman architect. Yes Virginia! There are alternatives to going out and sweating over a drafting board. For some the pen is mightier than the T.Square.

Saturday night we heard from Lois Langhorst who talked on "Women Architects and their Potential Roles in Creating Family Environments" and showed some stunning slides of residences she had designed over a long period of time. Later after Regi Goldberg, a young architect with her own firm in New York City presented "Symbolism in Arch., a Feminist approach to design." it was obvious that a Mexican stand-off was developing, only it involved our northern border instead of our southern one. A number of women from the University of Toronto spoke up loud and clear about what their questions and statements had been hinting at in the workshops. They seemed to think that most discussion about being women in architecture was totally unnecessary and that we should be discussing pure asexual architecture instead. They accused American women of lacking self confidence and dwelling on the problems we faced in this chauvinistic profession of architecture. On that point I disagree. The reason 400 of us had come to St. Louis was that we were women and we were in architecture and there were many elements pertaining to this fact that we wanted to discuss with our sisters to learn from them as to the best way to

proceed in a male dominated profession that would perhaps make it easier for many of us when we got our licenses and for the future generations. (Sounds prophetic, doesn't it?)

On this general theme it was a most successful symposium. For myself (one of 3% women in the O.U. architecture school) it was immensely encouraging and exhilarating to see that there are many who feel as I do about architecture and that I have competent support "out there" in my struggles.

Now, if any of you males are still reading by this point, I am getting to the best part. On Sunday I participated in a lively workshop entitled "Trends in Architectural Education, Trends in Architectural profession, and Architecture as a NON Profession." From this discussion came some thoughts that best describe why the fact that more women are entering the field of architecture is important to us all, female and male.

Like it or not, we women have nothing to lose in the profession as it stands. Right now we are almost nowhere as far as numbers in the profession, though this is changing. Because of this it is going to be the female element that will be most instrumental in instigating CHANGE in the profession. Although there might be those of you who think everything is peachy as it stands, I do not. I think as a profession it is much too structured and obsessed with balancing on its pedestal, therefore unwilling to obtain a communion with the people (you know-the ones we're supposed to be designing for) so we are knowledgeable of and responsive to their needs. If we cant

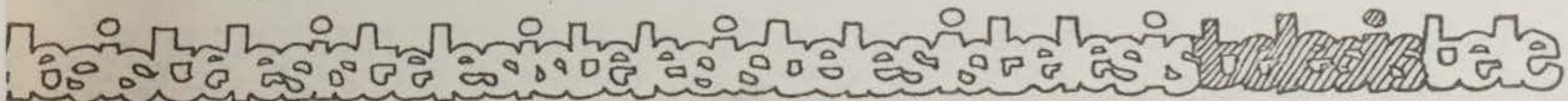

It is time the PIE was enlarged to include everyone who lives in our environment. We must realize we are people, not elitists, and that we have to go public if we are going to survive at all. Instead of thinking that the traditional firm is the only answer, we must be aware of alternatives like working for industrial firms, involving ourselves in recycling, renovation and rehabilitation programs for existing structures more community activity such as Community Design Centers. In short—we gotta speak their language! And within the firms, why must it be a principal and her flunkies? Why not a group effort like Joan Sprague has begun in Boston where a loose, open office with increased interaction hopes to bet away from the traditional hierarchies.

As students we must not be seduced by the establishment after we graduate. Must look for situations where we define our roles rather than trying to fit into existing roles. As for curriculum in our schools, the educational process can be enhanced for us and for them if we expand our projects into the community. We have passed the days when we can wait in our offices for clients to walk in and ask for ART. We have to start making attempts to go out and talk to the people..

If I have judged correctly the extent of energy and competence at this symposium, women will have a much needed good influence for change in the architectural profession. And it's about time, because as I said earlier, we go nothin' to lose.

A little nostalgia here. I talked to Prof. Fitzgibbon on the Wash. U. faculty who, early in his career was on the esteemed faculty at O.U. in the pre Bruce Goff days.

(Infact he was partially responsible for the hiring of Goff.) Yes, Prof. Fitzgibbon, times have changed.

Also- I had quite an interesting converstaion with the women from Auburn (where our beloved BOSS is going). They kept asking me, "What's a Kemp?" Pat McPheeters (her husband is the dean) and I were taling over beer when a non-architect friend of mine walked up and asked if she was the chaperone of all these "girls!" At which point she squared her shoulders and announced that she was a registered architect. You must get away from those stereotypes, boys! She also told me that they just couldn't wait for that "sweet 'ol by, Ed Kemp" to get down there to that sunny southern weather. I assured her that they were about to get "such a deal." You got your work cut out for you, Ed. get beyond thinking of ourselves as pure professionals, then we are locked into the never ending battle for a peice of the ESTABLISHMENT PIE. As far as this goes, anyone who is vaguely aware of what's been falling out about our ears in this country the past few years, knows that the establishment pie is putrid.

F O R S A L E

"Post" Versalog Slide Rule (book included, case included). Used 1 (one) semester in Intro. to Engineering, \$15.00. Roger Johns, 364-1409 after 5 p.m.

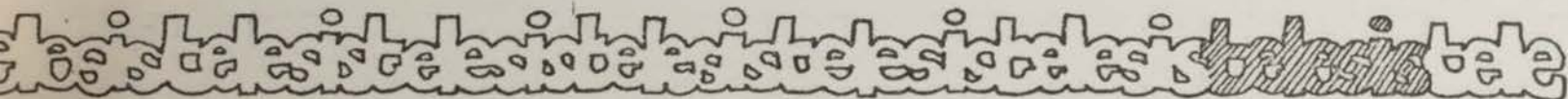

TREE PUMP DIAGRAM

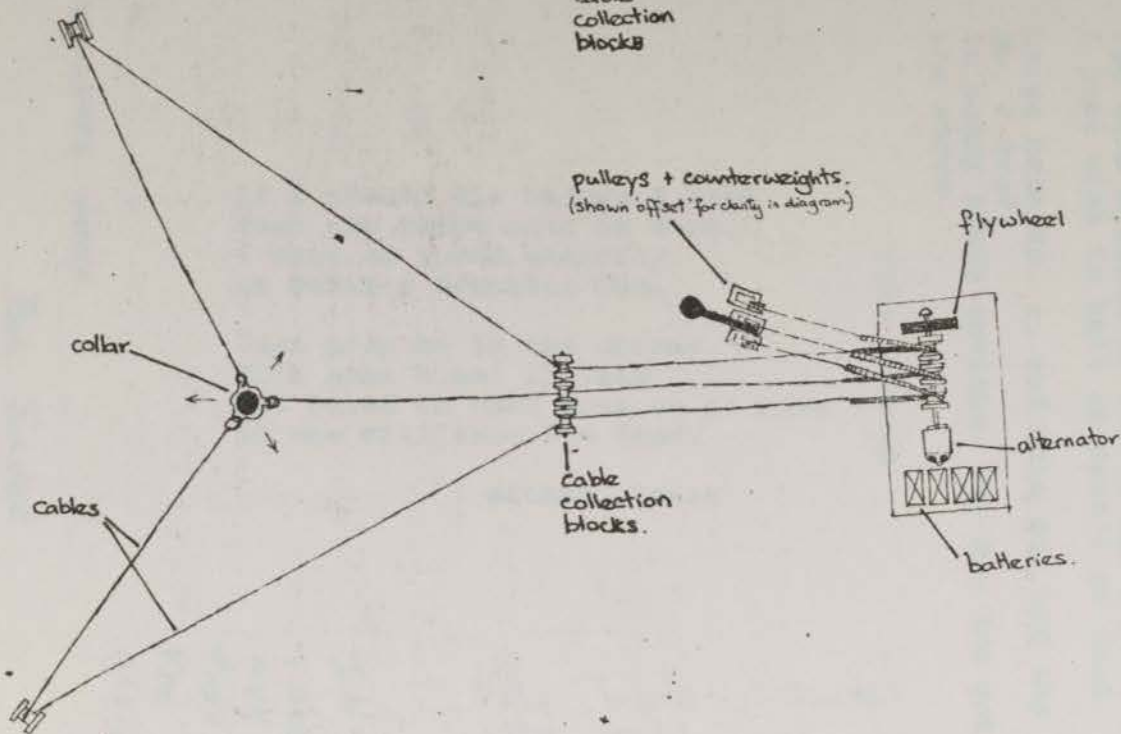
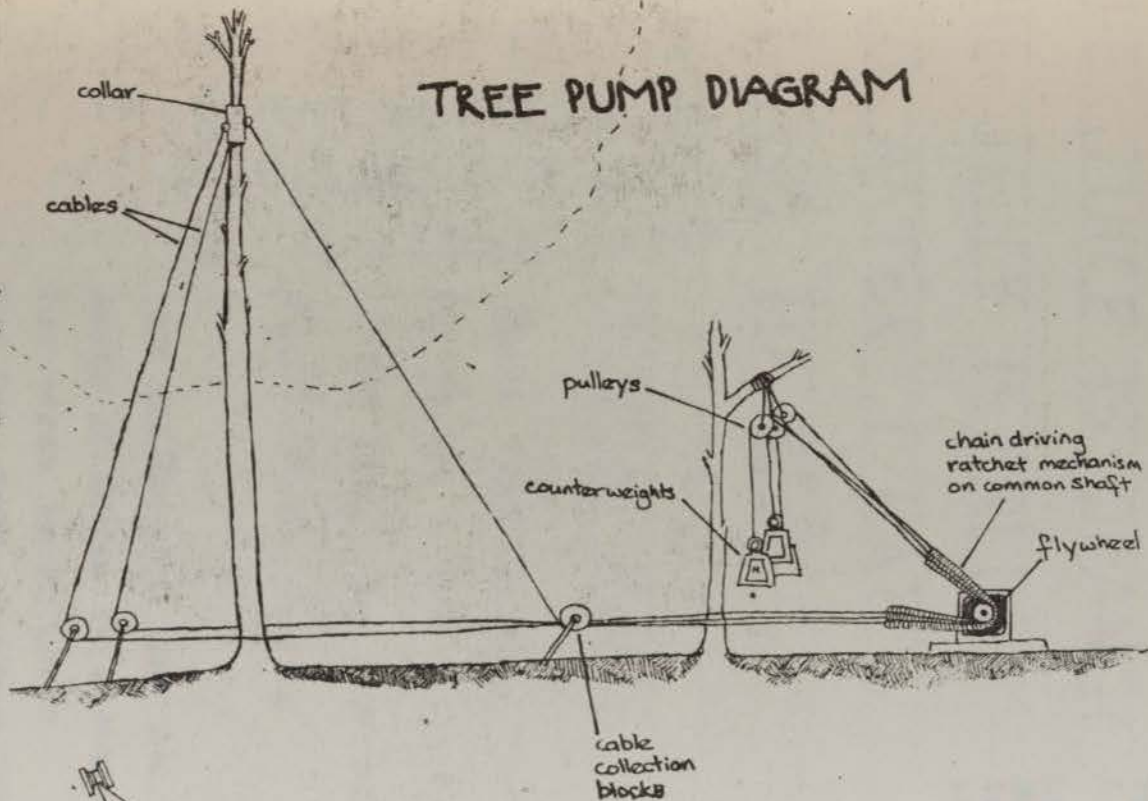

© David Stabb 1972
drawings by Stefan Sz from Stabb's originals
showing an early development.

From: Energy: survival blueprint #3

ROSES ARE RED...

THE JUICE IS ORANGE,
THE JELLY IS RED,
AND AFTER I EAT,
I'LL GO TO BED.

The wind outside is strong and bold;
I just wish to hell it wasn't so cold.

Notre Dame No. 1, and Ohio St. had the
No. 2 crew;
It seems kinda obvious, the Big Red got
the screw.

mike jackson

If I should die before I wake
Just one thing must be done,
I want to spend eternity
In Dodig's Graphics One.

Just prop me in the corner
With some H and 2h lead
And based on what goes on in here
No one will know I'm dead.

michael joest

CHUCK ENOS

BIRDS ARE SO TINY SO TINY
AND SMALL, YET I WISH WE
WERE FREE. AS FREE AS THEM
ALL - Mike Jackson

THE OUR REGENTS ARE OK
WHEN IT COMES TO GIVING MONEY AWAY
BUT MESS WITH SPORTS
THE THE STATE LEGISLATURE WANTS A SAY.

Bob Schurr

Table squeak
Table
WHY
WHY
IF
BUT
squawk
works
table
movers
Never works

IN THE BEGGINNING,
THINGS WERE BEGAN,
AND ONCE STARTED,
THEY PROGRESSED AT
THE PRESENT ROTTEN,
RAPID, RATE.

A. TAYLOR

Tim Pate

YOU WANT SIMPLY BECAUSE
FROM THE MOMENT YOU ARE BORN
YOU ARE TOLD WHAT YOUR LITTLE
WHY DESIRES. CHRIST HOUSER

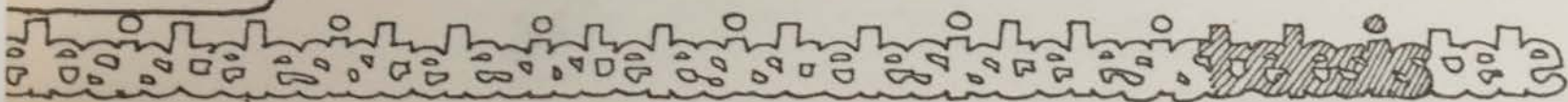

VIOLETS ARE BLUE...

THE MONEY FOR OUR DRAWING SCHOOL
HAS GONE INTO A SWIMMING POOL
AND WHILE OUR DRAFTING TABLES ROT
THEY BUILD A WELL LIT PARKING LOT

BUT EVEN THOUGH THE FUTURE FOR
OUR SCHOOL LOOKS PRETTY GRIM
AT LEAST WE KNOW OUR PRES WILL HAVE
A PLACE TO PARK AND SWIM.

REFLECTIONS ON PROPHECY. M. JOEST
OR (BASKING IN THE CHAUVINISTIC SUN)

THE MINI-SKIRTS KEEP RISING
THE MORE THE "TAIL" TO TELL
AND BRA-LESS BREASTS KEEP POPPING OUT
LIKE GIFTS FROM THE WISHING WELL

THE MAN WHO SPAKE - HE SPAKE THE "TRUTH"
HE WORD STRAIGHT FROM THE LORE
HE SIMPLY OPENED HIS EYES AND QUIPPED
BY SURELY LESS IS MORE

- KEITH LOCHRAN -

Just about the
Time you think
You can make
ends meet,
Some one
MOVES the
Ends. ^{cut}

M JOEST

Long Ago Buildings WERE
BUILT TO HOUSE MAN,
TODAY THEY ARE BUILT
TO DESTROY THE LAND.

Ed Kurtz

NO MATTER THE DICTION
IT IS PROBABLY THE ACTION.
PERFORMED BY THE JUNCTION
THAT MAKES IT FICTION

K M NIMY

I KNOW THAT THERE IS JUST NO WAY
THAT I CAN WRITE A POEM TODAY
(I'M MUCH TOO TIRED FROM MY FLIGHT
I WENT OUT STREAKING ALL LAST NIGHT)

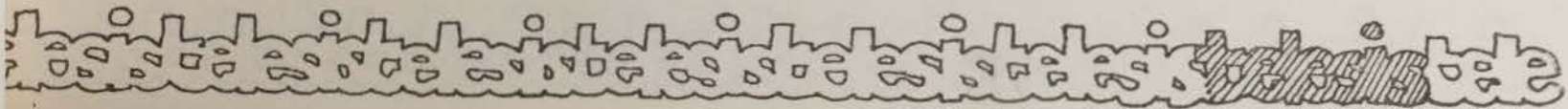

comment & sun

March 13, 1974

TELESIS:

Q.- What is a Kemp? (*the answer is in the stars, somewhere!)

I have never had a class with Mr. Kemp; and the possibilities, the success or failure that administration offers is quite beyond me. So any criticism of him can be taken as strictly personal. I too, am leaving the University. (eventually) So I look at this event as a somewhat distant observer. But, as Mr. Kemp is a neighbor of mine; and in his taking leave, I am certainly concerned as to wheather the quality of this former 'faculty row' is expected to go up or down as a result.

However, I am taking a positive attitude toward Mr. Kemp's announcement of his recent success, for him. It represents quite an opportunity. What happened to the one You found here? Mr. Kemp arrived at O.U. some time ago, in a barrage of surplus possibilities. I trust his leaving is not (taken as, or used as) a surplus fanfare. But, from that point of view, I do hope you will be able to dispose of the surplus before you go. But then who knows! That may be just what _____ needs.

Sincerely,

Paul R. Kelly
Paul R. Kelly

editorial comment to the main O.U. Architecture School restroom graffiti club.

A thick rammed earth or rock wall (2'-3' minimum) may be used to absorb solar heat during the day, store it and reemit it at night. see below

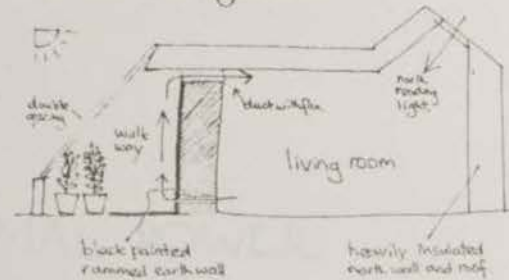

The ducts are closed during the day and opened at night when the shutters or metallised blinds are closed to insulate the windows. Air circulates by natural convection. see below

Diagram of Richard the Squatters Room Conversion.

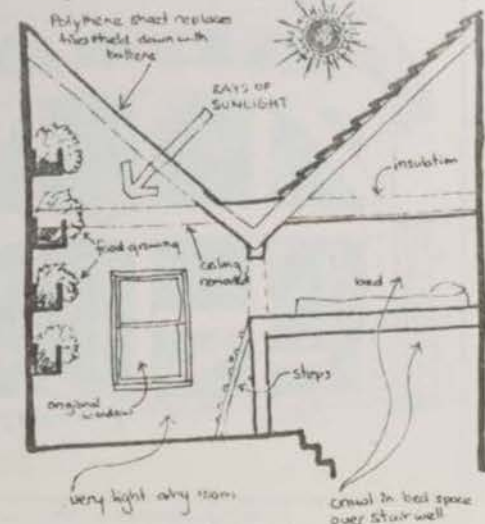

Basset Street, Kentish Town, 1973.

From: Energy: Surviving Squatters #3

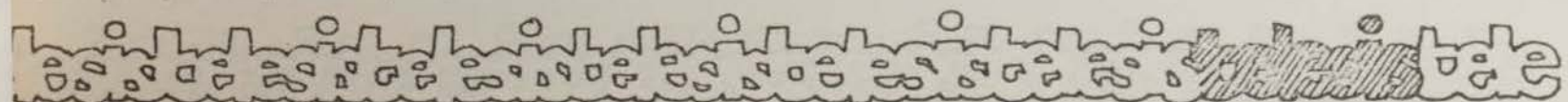

THE LIBRARY MEANS MORE THAN GRAPHIC STANDARDS!!!!!!!!!!!!

Attention! Due to some fancy footwork between our library and serials in the Main Library (that's magazines, not Fruit Loops), we have added three new magazines to our collection and have one more on the way.

First, we now officially subscribe to Architecture Plus, a periodical that is rapidly becoming the most popular in our collection.

Also, the library has joined the controversy surrounding the pure Form vs. vernacular architecture debate by subscribing to Oppositions, a magazine sponsored by the Institute of Architecture and Urban Studies, hangout for the "New York Five". Check the display in the library, then try the mag.!

On a more practical level, we are attempting to fill the gap in our housing and landscape architecture collections by taking the Journal of Housing, currently on the shelves and Landscape Architecture, which is on the way.

On the new books shelf, we have Anthrophysical Form, which deals with spatial form in two neighborhoods, one a subdivision in St. Louis, the other in India. Sound intriguing? Come by and give it a look!

Also new--Reekie's Design and the Built Environment, Places and Things for Experimental Schools, and a historical novelty, The Carpenter's Company, 1786 Rule Book. And for research in Urban Design, a really good bibliography on the subject--Urban Environments and Human Behavior.

We just passed National Library Week. Give my regards to Dewey (decimal)!!!

---- Bobbie B., Librarian

Don't be afraid to let words in your head out. People become lonely if they are afraid of what others might think. Man is said to be free, but he is not really free, he is simply conditioned.

C.H.

From: Guppy; Survival Beaport #3

ANIMAL POWER

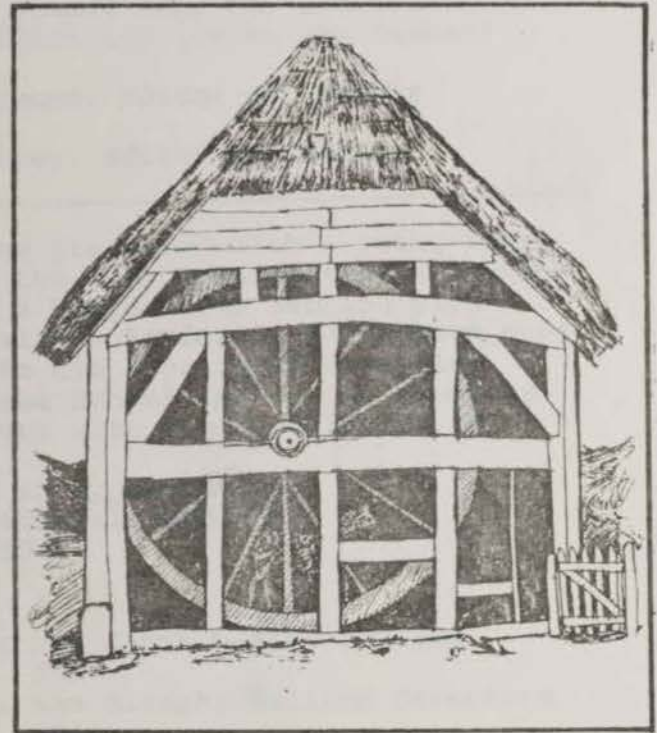

DONKEY WHEEL at Winton, Wiltshire. Demolished in 1908.

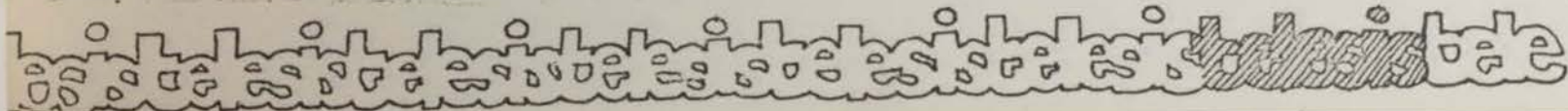

ANNUAL AWARDS AND ELECTIONS



New Officers SCAIA:

President -Tom Verdel
Vice President -Oliver Barfield
Secretary/Treasurer-Brent Butler

Reynolds Aluminum Award:

Charles Warner \$100
Ralph Dodig \$200

Tulsa Women's Architectural League:

Jude Ann Hamilton \$250

AIA Carrere Fund Scholarship:

Jude Ann Hamilton \$300
Dean Johnson \$600

AIA Medary Scholarship:

Deryl Redden \$500

Alph Rho Chi:

Leon Graber

AIA Certificate of Scholarship:

Ralph Dodig

AIA Silver Medal & Award:

Fung Chin
Gate Competition;

1st Prize: Ralph Dodig &
Randy Smith
Runner-up: Gary McElhaney

What's a Kemp Award

(1st Annual Book Award donated
by Prof. Edward Kemp for leadership
and unselfish service to the School)

John Caywood, Editor of Telesis
and
Mark Seiley, Editor of Telesis

Prof. Kemp was presented with a going away
present from the O.U. Architecture Students.
He was given a humidior for storing pipe
tobacco and also a Savinelli Meerschaum pipe
to commemerate his 7 years of unselfish
devotion to the School and to the students
in Architecture with the inscription of

"To Big Ed in Appreciation
OU Architectural Students
1974"

ASABAB:

1st Prize: Pat Johns Design I Class
\$50
2nd Prize: Ann Hirschi Balloon Structure
\$25
3rd Prize: Deryl Redden & Bret Karson
\$25

